

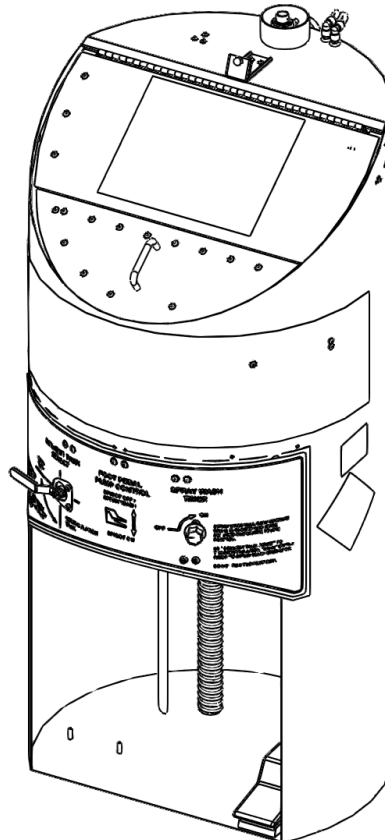

# Crystal Clean

PAINT GUN CLEANER  
OPERATORS MANUAL



# Table of Contents

|                                     |         |
|-------------------------------------|---------|
| Introduction, General Information   | Page 3  |
| Safety Instructions and Information | Page 4  |
| Important Safety Instructions       | Page 5  |
| Service, Fire, First Aid            | Page 7  |
| Environment                         | Page 8  |
| Installation Procedures             | Page 8  |
| Operating Procedures                | Page 11 |
| Servicing                           | Page 15 |
| Troubleshooting                     | Page 17 |
| Fluid flow diagram                  | Page 20 |
| Airflow diagram                     | Page 21 |
| Components diagram                  | Page 22 |
| Inner components diagram            | Page 23 |
| Warranty                            | Page 24 |
| Installation checklist              | Page 25 |

# I. Introduction

## A. Manufacturer's Statement

This manual will provide you with important information about the Solvent Paint Gun Cleaner and will instruct you on how to use this equipment in a safe manner.

The information contained in this manual is necessary for the safe, proper setup and operation of your Solvent Paint Gun Cleaner.

Keep this manual, along with the Safety Data Sheets (SDS) for the solvent in use, within easy reach of the operator of this parts cleaner.

The equipment described in this manual is subject to change. The manufacturer reserves the right to change equipment at any time as part of normal product improvement. Some improvements may have been made after this manual was printed. For the latest information on your equipment, contact the manufacturer.

## B. General Information



### **READ AND UNDERSTAND ALL LABELS, SDS, AND THIS INSTRUCTION MANUAL BEFORE USE.**

The Industrial Solvent Paint Gun Cleaner is an economical, safe, and innovative system designed to clean parts. Solvents, once contaminated, must be disposed of properly. Consult your local environmental management agency for additional guidance and other potentially hazardous materials compliance requirements.

Install your paint gun cleaner on a flat, level surface in an area provided with adequate ventilation. Avoid repeated or prolonged breathing of vapors. Do **NOT** use compressed air to dry parts as this may cause a high concentration of vapors in the immediate area. Local exhaust ventilation should be used in areas of high vapor concentration. Provisions for determining and maintaining adequate ventilation are the responsibility of the operator.

Make sure the paint gun cleaner is connected to proper grounding.

Do **NOT** allow the parts cleaner to operate unattended.

## II. Safety Instructions and Information

Complete safety in use is dependent upon proper use and handling of the paint gun cleaner in your workplace.

It is important that you follow the instructions provided in this manual. If you fail to read, understand, and follow all procedures in this manual, you may cause or suffer personal injury.

**DO NOT OPERATE ELECTRICAL EQUIPMENT INSIDE OF PAINT GUN CLEANER.**



**USE ONLY MANUFACTURER RECOMMENDED SOLVENTS.  
USE OF INCOMPATIBLE CHEMICALS CAN RESULT IN PRODUCT  
DAMAGE AND RISK OF SERIOUS INJURY OR DEATH.**

This equipment is designed for use only with manufacturer recommended solvents. Do **NOT** add any other chemicals to the cleaning agent including, but not limited to, kerosene, fuel oil, gasoline, chlorinated solvents, brake cleaner, or detergents. The use of any other solvents could potentially cause a hazardous condition.

Avoid contact with eyes or skin. Wear protective eyewear, gloves, and clothing.

Operation should be conducted in a manner, which prevents splashing, or spillage. Any solvent spills should be promptly and properly cleaned up. Soak up all spills with absorbent material. Remove and dispose of all soaked material in accordance with regulatory requirements.

This unit is **NOT** intended for outdoor operation.

Do **NOT** leave solvent-soaked rags in parts cleaner or in uncovered containers.

Do **NOT** obstruct the cover. Do **NOT** substitute with any other type of cover positioning device. Do **NOT** leave large objects in the parts cleaner or hang anything on the cover that could prevent the cover from closing.

Do **NOT** place heavy objects on edges or front of sink. Although this paint gun cleaner is designed to be stable, uneven weight distribution could cause a hazardous condition, over which the manufacturer has no control.

Do **NOT** contaminate cleaning solvents with gasoline, alcohol or flammable liquids.

When cleaning parts: remove all gasoline or any other flammable liquids into a proper disposal container before placing the part into the paint gun cleaner. Gasoline has a low flash point. If gasoline is added, the flash point of the solvent may be lowered.

Do **NOT** spray aerosols into or around this machine. Install the equipment in an area away from heat, sparks, and open flame. Never put hot parts into the solvent.

Do **NOT** use compressed air to dry parts. Be sure parts are completely dry prior to reassembly.

Close the lid when equipment is not in use. This will reduce solvent loss due to evaporation.

## **A. Important Safety Instructions**

1. Read and become familiar with the Material Safety Data Sheet for the solvents and the Operator's Manual for safe use of this equipment. Follow all safety information as described on the solvent label (or in the SDS).
2. To reduce the risk of fire, do **NOT** install within 3' of any ignition source such as bench grinders, welding equipment, etc. Do **NOT** operate equipment in the vicinity of open containers of flammable liquids (gasoline). Do **NOT** place hot parts in the Spray Gun and Equipment Cleaner.
3. Use only as described in this manual. Use only manufacturer's recommended attachments. Do **NOT** modify this machine in any way.
4. **ALWAYS WEAR SAFETY GLASSES.** Everyday eyeglasses only have impact resistant lenses, they are not safety glasses.
5. Do **NOT** operate any electrical equipment inside or around the unit.
6. Do **NOT** smoke, eat or drink in the work area.
7. Do **NOT** modify these machines.
8. Do **NOT** operate this unit in any manner that will cause splashing or cause mist to form.
9. Use **ONLY** the solvent provided. Do not remove any solvent. The use of other chemicals or paints may potentially cause a hazardous condition.
10. Adjust nozzle or flow-thru brush so solvent is directed to inside the sink only.
11. In any emergency, close the lid, turn off the unit controls, and disconnect the air supply.
12. Keep cover closed whenever unit is not in use.
13. Do **NOT** remove fluid from this equipment or it may cause malfunction or unsafe conditions.
14. Ensure all bonding and grounding straps are in place and unit is connected to a proper earth ground.

15. Do **NOT** smoke, eat, or drink in the work area. Use good personal hygiene. Wash thoroughly with soap and water after handling and before eating, drinking, or using tobacco products.
16. AVOID repeated or prolonged breathing of vapors. Ensure the air exhaust system is connected and working properly. Exhaust from machine must be vented directly to the outside atmosphere or through an existing exhaust system.
17. Use **ONLY** the solvent provided. Do not remove any solvent. The use of other chemicals or paints may potentially cause a hazardous condition.
18. Do **NOT** operate the unit if any leak is apparent or occurs during use. Contact your Crystal Clean sales/service representative.

## **SAVE THESE INSTRUCTIONS**

## B. Service

Call your representative should your paint gun cleaner need service and always disconnect the air supply when servicing.

Inspect and keep in good working order the air supply and all grounding wires. If components show signs of damage or wear replace immediately. All work should be done by a trained technician.

Do **NOT** replace pump before disconnecting the air supply and draining excess solvent from the liquid tubing lines.

Do **NOT** modify the lid or impede the lid's ability to close.

## C. Fire

Do **NOT** add any other chemicals to the cleaning agent including, but not limited to, kerosene, fuel oil, gasoline, chlorinated solvents, brake cleaner, or detergents. The use of any other solvents could potentially cause a hazardous condition.

Under certain conditions the solvent could burn. Do **NOT** leave large objects in the parts cleaner or hang anything on the cover that could prevent it from closing in the event of a fire. A closed cover contains and smothers the fire inside the metal sink.

**IN CASE OF FIRE:** Use a Type ABC or Type BC fire extinguisher. Do **NOT** use water. Contact your local fire department.

**IN AN EMERGENCY, UNPLUG THE ELECTRICAL SUPPLY TO THE UNIT.**

## D. First Aid (Medical instructions)

Please note that these First Aid Precautions are for uncontaminated cleaning solvents only. Once the solvent has been contaminated (i.e. with oil, grease, antifreeze, etc.), safety precautions should be adjusted according to the type of contaminant.

1. **EYES:** Contact may cause slight to moderate irritation. **For direct contact, flush eyes with water for 10-15 minutes or until the material has been removed; be sure to remove contact lenses, if present, and to lift the upper and lower lids during rinsing. If irritation from vapors or mists develops, move victim into fresh air. Get medical attention if irritation persists.**
2. **SKIN:** Prolonged or repeated contact tends to remove skin oils, possibly leading to dermatitis. **Wash skin with soap and water. Remove contaminated clothing, rinse shoes and launder clothing before reuse. If irritation or pain develops or persists, seek medical attention.**
3. **INHALATION (Breathing):** Prolonged exposure to concentrate-mist or vapor may cause mild irritation of nasal passages or throat and may have other central

nervous system effects. **Remove to fresh air immediately. Do not leave victim unattended. Get medical attention if irritation persists.**

4. **INGESTION (Swallowing):** (Uncontaminated cleaning solvent) **Drink 4 to 8 ounces of water and seek medical attention. DO NOT** induce vomiting.

## **E. Environmental**

1. **Avoid spilling solvent.** Spilled solvent can create slippery conditions, clean it up immediately. Close off area to traffic. Wear appropriate personal protective equipment to prevent eye and skin contact. Consult the Safety Data Sheet for instructions on clean up and disposal.
2. **Contain leaks promptly.** Notify local environmental authorities if necessary.
3. **Solvents, when used to clean grease and oil, must be disposed of properly. Consult your local environmental management agency for additional guidance and other potentially hazardous materials compliance requirements.**
4. **Do NOT remove devices designed to reduce solvent evaporation except to process work or to perform maintenance.**
5. **For further information consult the Safety Data Sheet provided by the solvent supplier.**

## **III. Installation Procedures**

Before installing the model 6A-000-A/6A-000-M Gun Cleaner, have a location picked out that allows you to easily install the exhaust hose to an outside source. Make sure that this location does not interfere with any doorways.

You will require the following items when installing a Gun Cleaner:

11. Five gallons of clean solvent (Be sure to use two-bung pail)
12. 12- inch adjustable wrench or bung wrench
13. Funnel
14. Flat tip screwdriver
15. 5/16" socket with ratchet.
16. 9/16" wrench



# Installation Procedures

(See Pages 16 &17 for component locations)

## 1. *Installing the Manual and Automatic Gun Cleaner:*

- A. In the lower compartment, run the main grounding strap through the access hole (11) in the back of the compartment and connect it to a ground source.
- B. In the lower compartment, connect the “dirty rinse holding tank” ground strap to the dirty rinse holding tank.
- C. In the lower compartment, make sure the drain hose is inserted into the dirty rinse holding tank (2). (See step P if hooking up an automatic gun cleaner 6A-000-A)
- D. Locate and remove clamp from the exhaust using a flat tip screwdriver or a 5/16” socket.
- E. Locate the exhaust hose in the sink compartment and loosely place clamp around it.
- F. Slide exhaust hose over the Air Amplifier and exhaust coupler (9), then tighten clamp around the base of the exhaust using a flat tip screwdriver or a 5/16” socket. Connect the other end of exhaust hose following local regulations.
- G. If needed, locate manual brush (18) in the sink compartment and slide the manual brush hose over main solvent spout (25).
- H. In the sink compartment locate the 2-inch cap (19) for the clean wash tank.
- I. Remove cap by turning it counter-clockwise using a 12-inch adjustable wrench.
- J. Using a funnel, pour approximately 4 gallons of clean solvent into the clean wash tank (14).
- K. Re-install cap on the clean wash tank.
- L. Pour approximately 1 gallons of clean solvent in the sink (16). This will drain into the dirty rinse holding tank (2).
- M. Inside the lower compartment (3) on the right side, connect an air hose nipple to the air filter/regulator (30).
- N. Connect air hose to the regulator.
- O. Turn on the air supply and verify that the gun cleaner air regulator is set to 80 PSI. Do NOT exceed 85 PSI. If not see troubleshooting section.

The following pertains to the automatic only:

- P. In the lower compartment make sure the automatic suction tube is also inserted into the 2-bung recirculating can (13). (See step C above)

## 2. *Installing the Direct Connect System (DCS):*

- A. Insert the dirty transfer straw into the 2-bung recirculating can (13) (into the same hole the drain hose goes into).
- B. Remove brass plug from recycler's inlet port using a 9/16" wrench.
- C. Locate the "Distillation unit hose" behind gun cleaner. Twist hose counterclockwise 5 times and then thread it into the recycler's inlet port using a 9/16" wrench.
- D. Thread clean transfer straw into the 3/4" bung on the CC Drum lid.
- E. Locate the "CC Drum hose" behind gun cleaner and attach it to the clean transfer straw. Tighten clamp using a flat tip screwdriver or a 5/16" socket.
- F. Pour 15 gallons of clean solvent into the CC Drum. Do not transfer any solvent until the 2-bung recirculating can is full, and the clean wash tank is empty. (Refer to the Gun Cleaner operation section of this manual for this step.)
- G. Refer to the recycler set up manual to set up the basket ring and bag in the distillation chamber of the recycler.

## IV. Operating Procedures

### 1. Operating the Manual Gun Cleaner:

#### Tank Selection Valve

- Rotate Clockwise to select the Fresh Tank
- Rotate Counter-Clockwise to select the Recirculation Tank

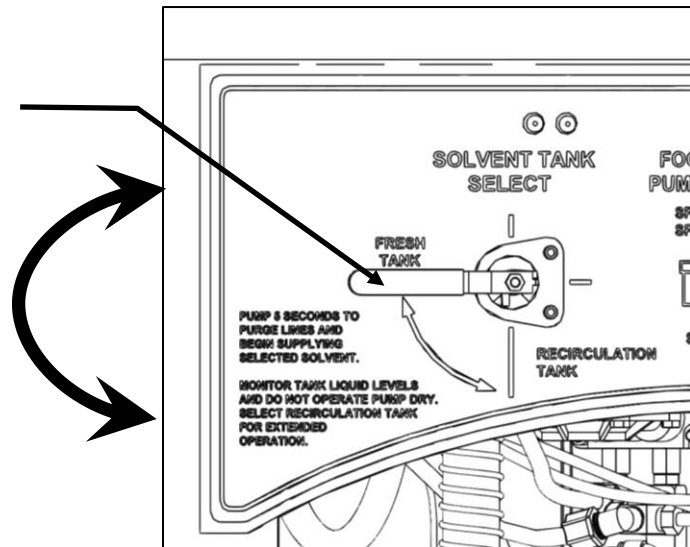

#### Foot Pedal Control

- Press Foot Pedal down to run selected liquid through Manual Wash Spigot
- Note: Foot Pedal pressed down will override the Automatic Spray Wash Function.

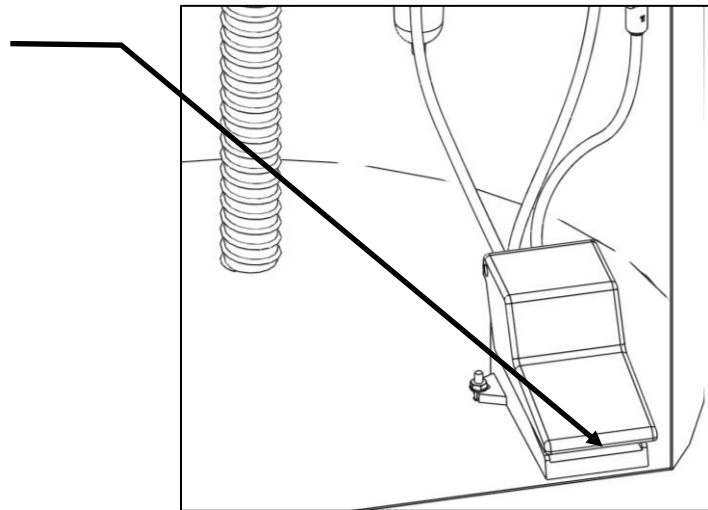

#### Manual Wash Spigot

- Liquid will come out from Manual Wash Spigot when the Foot Pedal Control is pressed down.
- Flow rate can be adjusted using the Spigot Flow Control Valve near the pump.

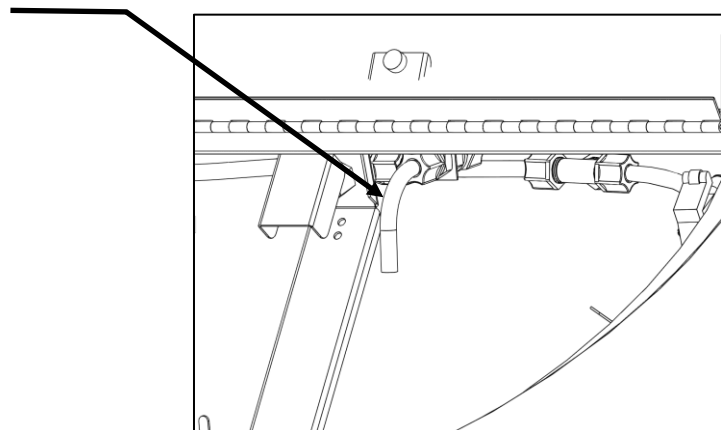

### Spigot Flow Control Valve

- Rotate Clockwise to reduce Manual Wash Spigot flow rate
- Rotate Counter-Clockwise to increase Manual Wash Spigot flow rate.
- Note: typically, 1/3 to 1/2 turn Counter-Clockwise from full closed will be sufficient for adequate flow.

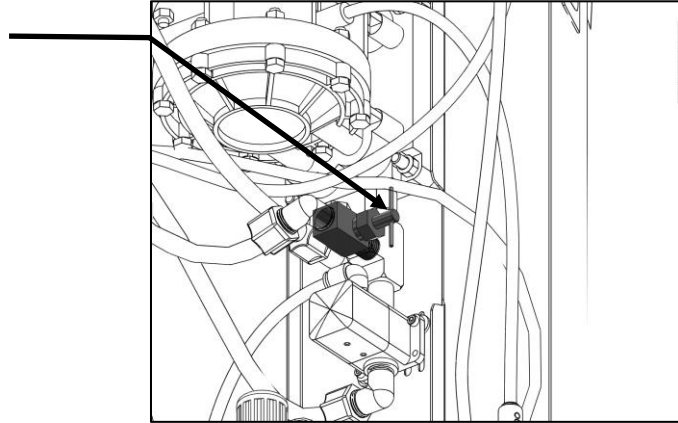

#### A. Fresh Solvent Operation:

- i. Turn the Solvent Tank Select Valve to Fresh Tank.
- ii. Place your foot on the foot pedal and push down.
- iii. Fresh Solvent takes approximately 3-5 seconds before it begins to flow out of spout. (If solvent does not come out, see troubleshooting section)

#### B. Recirculating Solvent Operation:

- i. Turn the Solvent Tank Select Valve to Recirculation Tank.
- ii. Place your foot on the foot pedal and push down.
- iii. Recirculating Solvent takes approximately 3-5 seconds before it begins to flow out of spout. (If solvent does not come out, see troubleshooting section)

Note: when switching between Fresh and Recirculating Solvent use, allow 3-5 seconds of operation to purge the other solvent from the lines.

## 2. Operating the Automatic Gun Cleaner:

### Automatic Spray Wash

- Rotate the Knob Clockwise to turn on the timer.
- The timer will automatically run for a short period of time, rotating Counter-Clockwise counting down, and then shut off.
- Rotate the knob Clockwise to add more wash time.

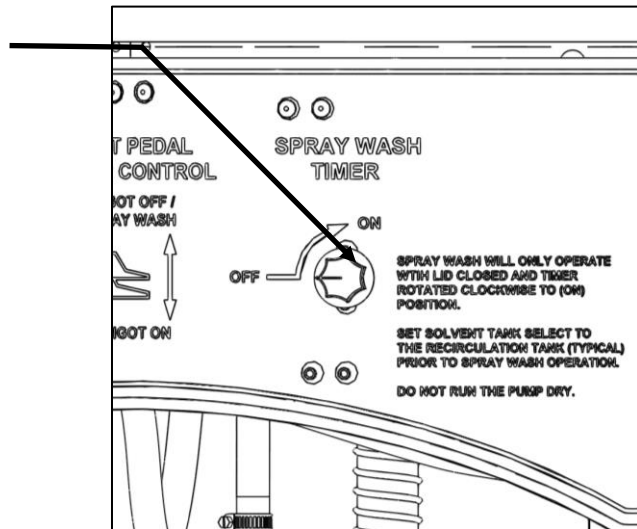

### Lid Switch

- Automatic Spray Wash protection switch.
- With lid raised, the Lid Switch will prevent the Automatic Spray Wash from operating.
- With lid closed, the Lid Switch will be pressed down, allowing Automatic Spray Wash Operation.
- Mounting bracket allows position adjustment of switch to ensure proper operation with lid movement.

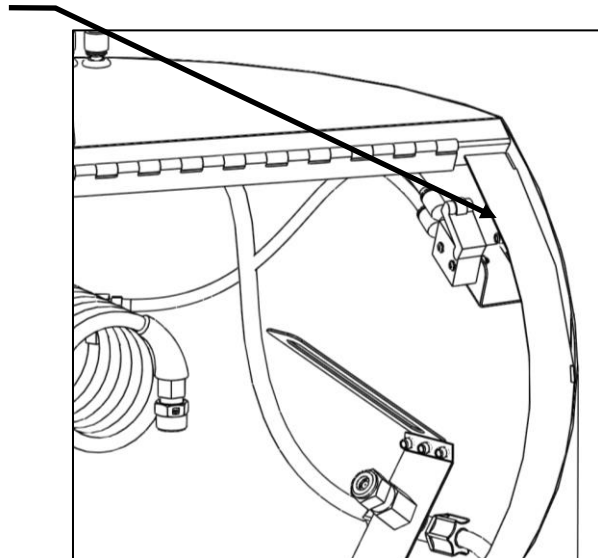

### A. Automatic Rinse Operation:

- i. Place paint guns and other equipment to be cleaned in the appropriate cradles in the sink compartment.
- ii. Close lid to sink compartment.
- iii. Rotate the Wash Timer knob clockwise to ON to start automatic cleaning.

### B. Fresh Solvent Operation:

- i. Turn the Solvent Tank Select Valve to Fresh Tank.
- ii. Close the lid and rotate the Wash Timer knob clockwise to ON to start automatic cleaning.
- ii. Fresh Solvent takes approximately 3-5 seconds before it begins to flow out of spout. (If solvent does not come out, see troubleshooting section)

C. Recirculating Solvent Operation:

- i. Turn the Solvent Tank Select Valve to Recirculation Tank.
- ii. Close the lid and rotate the Wash Timer knob clockwise to ON to start automatic cleaning.
- ii. Fresh Solvent takes approximately 3-5 seconds before it begins to flow out of spout. (If solvent does not come out, see troubleshooting section)

Note: when switching between Fresh and Recirculating Solvent use, allow 3-5 seconds of operation to purge the other solvent from the lines.

3. Operating the Direct Connect System (DCS):

- A. Make sure that you have recycled 5 gallons of solvent and that the CC Drum is full.
- B. Install a new recovery bag into distillation chamber of recycler (See recycler's operator manual).
- C. Turn the main air supply switch to "ON".
- D. Turn the mode switch to "DCS" (Direct Connect System).
- E. Once transfer has been completed (the distillation chamber is full, or the 2-bung recirculating can is empty) turn On/Off switch to "OFF".

Note: The transfer should only be performed when you have run out of clean wash solvent.

# V. Servicing

## 1. Customer Servicing

| Service task   | Procedure  | Frequency                    |
|--|--|------------------------------|
| 1. Cleaning the 2-bung recirculating can                                     | <ul style="list-style-type: none"> <li>- Remove 2-bung recirculating can from lower compartment</li> <li>- Remove hoses form recirculating can.</li> <li>- Pour 1 gallon of clean solvent into 2 bung recirculating can.</li> <li>- Agitate contaminants with a stir stick or scrub brush.</li> <li>- Empty contents into a waste drum.</li> <li>- Repeat cleaning process until satisfied.</li> </ul> | Every 3 months or as needed. |
| 2. Air regulator bowl cleaning   | <ul style="list-style-type: none"> <li>- Disconnect air hose from air regulator.</li> <li>- Unscrew bowl from regulator by turning it counter-clockwise</li> <li>- Empty bowl of its contents</li> <li>- Re-attach bowl to air regulator.</li> <li>- Re-connect air to air regulator</li> </ul>  | Weekly or as needed          |
| 3. Cleaning rinse nozzles  | <ul style="list-style-type: none"> <li>- Disassemble the spray nozzle by removing the retainer nut.</li> <li>- Remove the internal disks and clean debris from the screen and orifices.</li> <li>- Reassemble.</li> </ul>  | Weekly or as needed          |
| Make sure to service your air compressor regularly as per operator's booklet |  |                              |

### Spray Nozzle Assembly:

Disassemble spray nozzle and inspect the Disk, Core, and Strainer for debris. Clean all parts and reassemble.

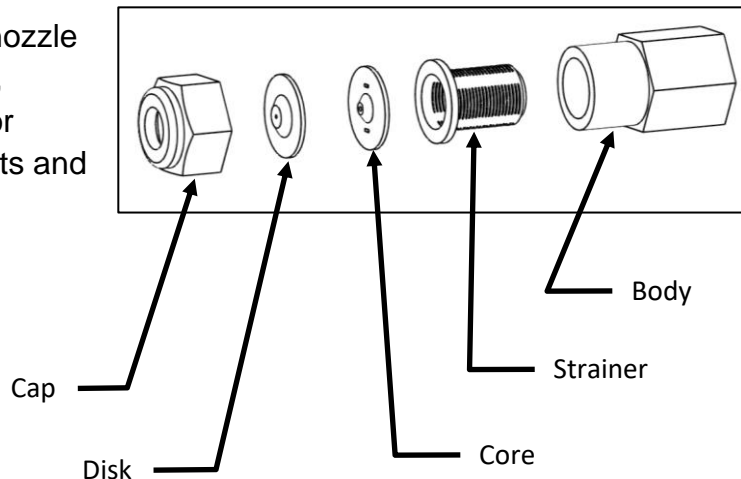

## 2. Crystal Clean Servicing Procedures

1. Bring 1 two-bung recirculating can of clean solvent and a bung wrench.
2. Using the existing solvent in unit (if possible) check to see that pump and systems are working properly. If they are, move to section 3 if not, resolve issues. If not, see Troubleshooting section. If needed, please contact manufacturer for assistance.
3. Use any remaining solvent in the clean tank to clean the workstation and exterior of the unit. Make sure to pump any remaining solvent into the two bung-recirculating containers. If there is no clean solvent remaining, use the recirculating solvent to clean the workstation and use a small amount of clean solvent to rinse.
4. Remove the ground strap, drain hose, automatic suction tube (if applicable) and dirty transfer straw (if applicable) from the two-bung can, located underneath the unit. Slide the two-bung can and secondary container out from underneath the unit. Remove the old two-bung can from the secondary container. Place the secondary container back underneath the unit and place the drain hose, and siphon tube inside.
5. Remove the 2" bung on the clean tank located in the sink. Using a funnel, pour approximately 4 gallons into the tank. Place the two-bung can with the remaining solvent (approximately 1 gallon) back inside the outer container. Insert the pump, drain hose, automatic suction tube (if applicable) and dirty transfer straw (if applicable) into the can. Replace the ground strap and slide it back into the base of the unit.
6. Check all connections and pump operation as noted in the Operating Procedures sections 1 & 2.



## VI. Troubleshooting

1. Symptom: I press on the foot pedal and no solvent is coming out of the spout (even after 5 seconds).

What to look for:

- Can you hear the diaphragm pump running?  
Yes – inspect the liquid supply hoses for debris or kinks. Inspect the fresh solvent supply from the upper tank rear fitting. Inspect the recirculating hose and tube for debris. Verify the selector valve is fully set to Fresh Solvent or to Recirculating Solvent.  
No – inspect the air supply and verify 80 PSI is being provided through the regulator. Inspect the spigot and spray nozzles for debris and clean and check for kinks in hoses.
- Is there solvent present in the selected wash tank?
- Do you have 80 PSI of air going to unit?  
If there is not enough air going to the unit, correct the air supply

2. Symptom: I turn on the automatic timer and nothing happens

What to look for:

- Can you hear the diaphragm pump running?  
Yes – inspect the liquid supply hoses for debris or kinks. Inspect the fresh solvent supply from the upper tank rear fitting. Inspect the recirculating hose and tube for debris. Verify the selector valve is fully set to Fresh Solvent or to Recirculating Solvent.  
No – inspect the air supply and verify 80 PSI is being provided through the regulator. Inspect the spigot and spray nozzles for debris and clean and check for kinks in hoses.
- Is there solvent present in the selected wash tank?
- Do you have 80 PSI of air going to unit?  
If there is not enough air going to the unit, correct the air supply

3. Symptom: The automatic rinse pump is working but fluid is not coming out of nozzles.

What to look for:

- Clean nozzles as per servicing section of this manual.
- Verify your 2 bung-recirculating can contains solvent.
- Verify that the automatic rinse fluid lines are not kinked or pinched.

4. Symptom: The automatic rinse pump is working but all the fluid comes out of the spigot and little to no fluid comes out the nozzles.

What to look for:

- The needle valve on the pump assembly is opened too far. (refer to page 14) Turn clockwise to reduce flow to the spigot.

5. Symptom: I press on the foot pedal and too much fluid flow comes out of the spigot.

What to look for:

- The needle valve on the pump assembly is opened too far. (refer to page 14) Turn clockwise to reduce flow to the spigot.

7. Symptom: I press on the foot pedal and too little or no fluid flow comes out of the spigot.

What to look for:

- The needle valve on the pump assembly is closed too far. (refer to page 14) Turn counterclockwise to increase flow to the spigot.

6. Symptom: Every time I touch the Gun Cleaner, I get shocked

What to look for:

- Make sure ground strap are connected as per operating section of this manual.

7. Symptom: I turn the mode switch to DCS (Direct Connect System) and the dirty solvent is not transferring to the recycler?

What to look for:

- Is there recirculating solvent in the 2 bung-recirculating can?
- Is there air going to the dirty transfer pump?
- Is the air supply switch turned to “ON”?
- Verify that the dirty transfer pick-up straw is in the 2 bung recirculating can
- Verify that the dirty transfer pick-up straw is not blocked by sludge or debris.

8. Symptom: I turn the mode switch to DCS (Direct Connect System) and the clean solvent is not transferring to the clean wash tank?

What to look for:

- Is the float on the CC drum of the recycler all the way up?
- Is the air supply switch turned to “ON”?
- Is there air going to the clean transfer pump?
- Verify that clean transfer tube is properly connected to the clean suction straw on the CC Drum.

Call the manufacturer for further assistance.

# FLUID FLOW DIAGRAM

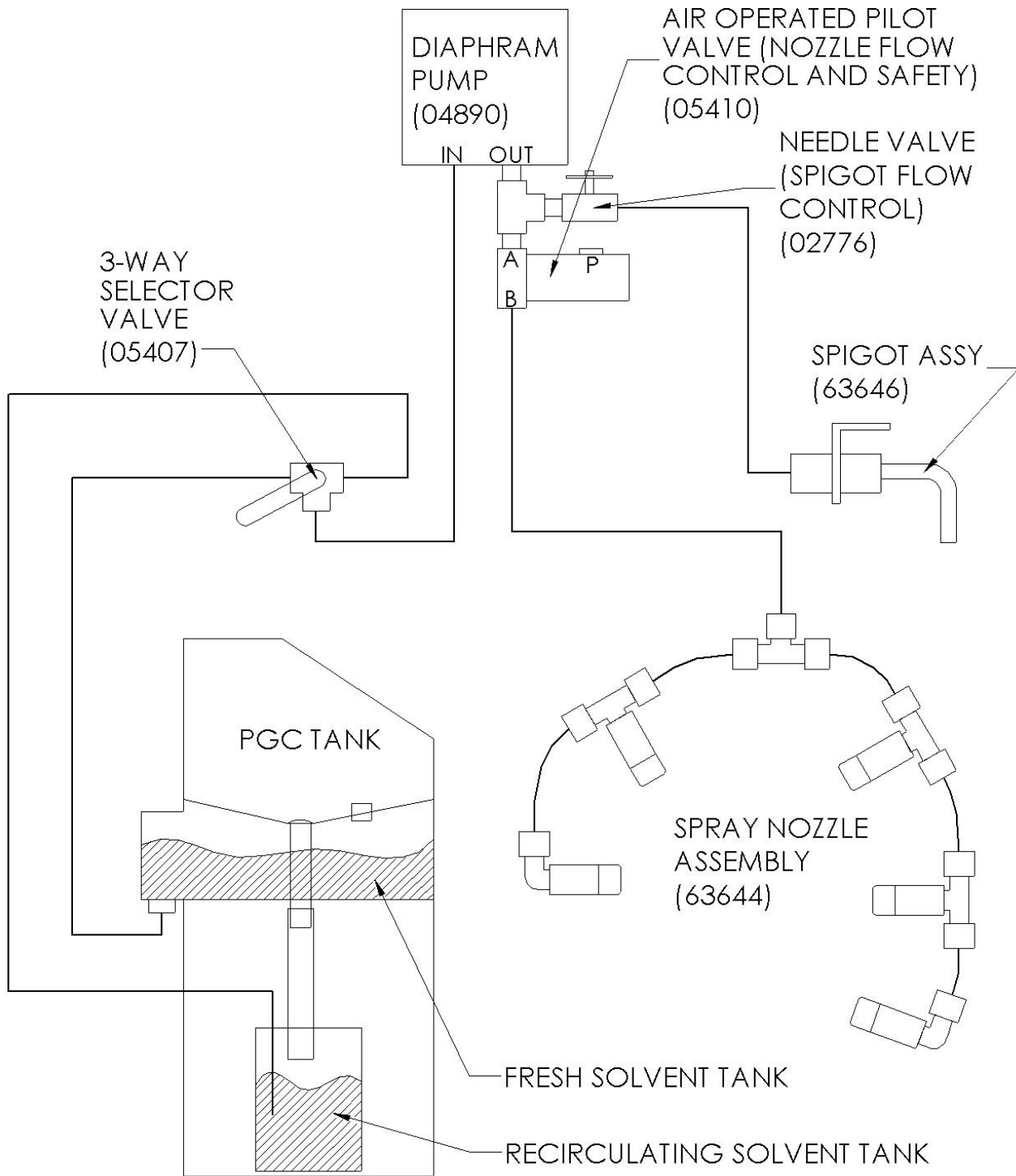



# Components Diagram

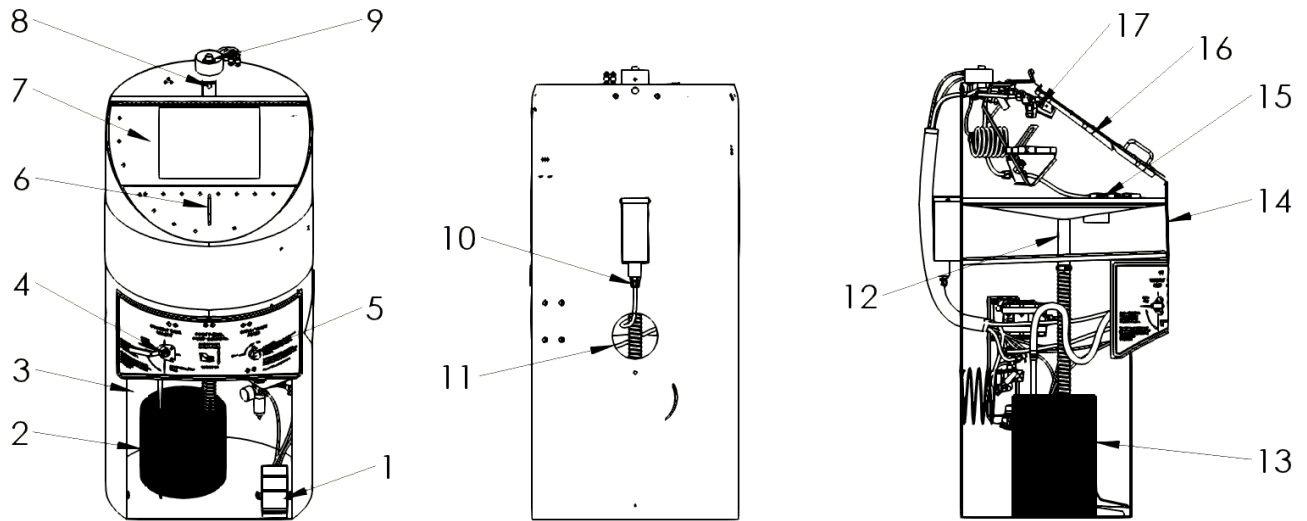

- 1. Manual pump pedal assy (63645)
- 2. Secondary container
- 3. Lower compartment
- 4. Solvent selection switch (05407)
- 5. Automatic wash timer assy (63657)
- 6. Lid handle (04889)
- 7. Lid to sink compartment
- 8. Lid stopper (04845)

- 9. Exhaust air amplifier (04842)
- 10. Drain for clean wash tank (05162)
- 11. Access hole
- 12. Drain
- 13. 2 bung recirculating can
- 14. Clean wash tank
- 15. 2" cap for clean wash tank (04926)
- 16. Sink compartment
- 17. Manual wash spigot assy (63646)

# Inner Components diagram

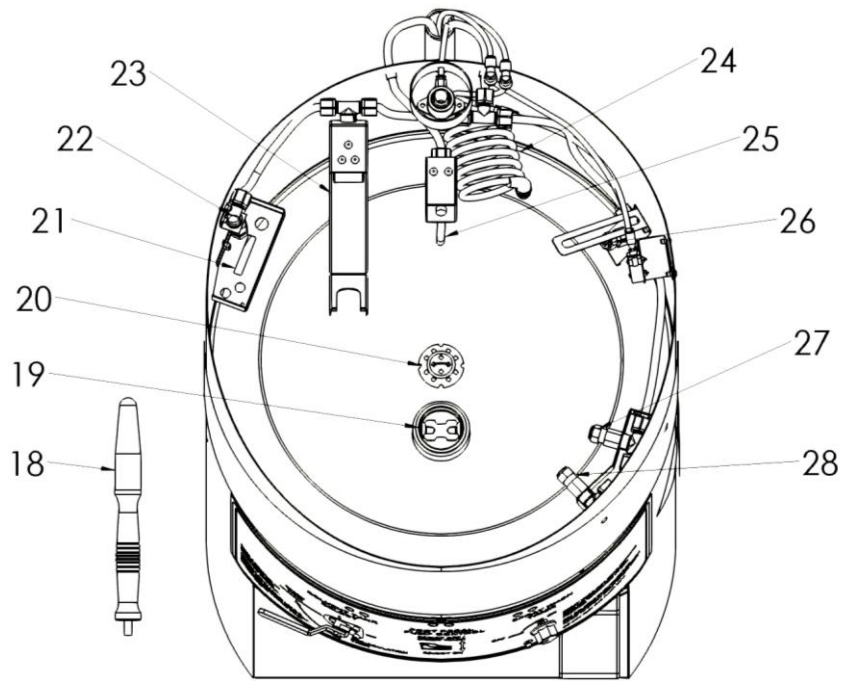

- |   |  |
|---|--|
| 18. Flow through brush (K8169)  | 25. Manual wash spigot assy (63646)  |
| 19. Clean tank fill cap (04926)   | 26. Siphon paint cup rinse nozzle (Automatic only)<br>(05166, 05167, 05168, 05545, 05169)    |
| 20. Drain hole screen (61987)   | 27. Siphon gun exterior rinse nozzle (Automatic only)<br>(05166, 05167, 05168, 05545, 05169) |
| 21. Gun nozzle shelf (Automatic only) (63654)                                       | 28. Siphon gun interior rinse nozzle (Automatic only)<br>(05166, 05171, 05172, 05545, 05169) |
| 22. Overhead shelf nozzle (Automatic only)<br>(05166, 05167, 05168, 05545, 05169)   | 29. Diaphragm pump (04890)   |
| 23. Gravity feed gun nozzle (Automatic only)<br>(05166, 05167, 05168, 05545, 05169) | 30. Air regulator (05084)  |
| 24. Automatic airline hose (04952)  |  |

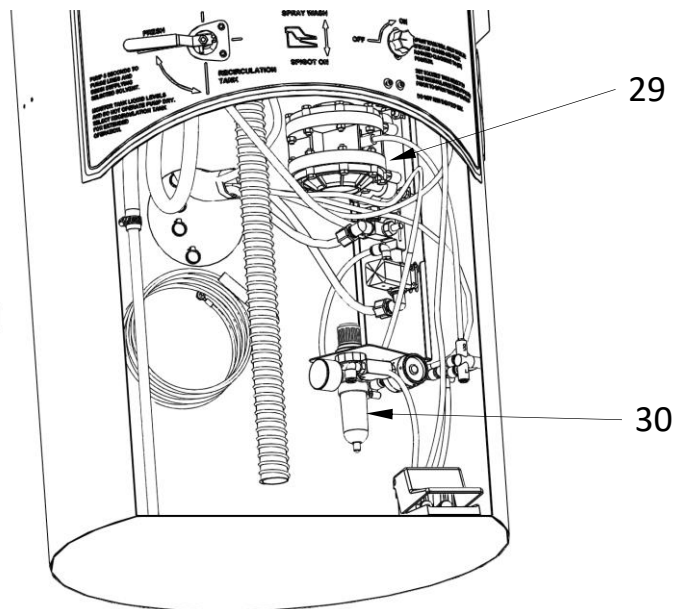

# XIII. WARRANTY

## LIMITED WARRANTY AND LIMITATION OF REMEDIES AND DISCLAIMER.

(1) Fountain Industries, LLC "Fountain" warrants the Equipment to be free from defects in material and manufacture and to conform to specifications for the Equipment at the time of shipment. This warranty is applicable only if the Equipment is installed, operated and maintained in accordance with factory recommendations and procedures, including, but not limited to, the use of Fountain's approved solutions or accessories. If any Equipment fails to conform to the specifications or samples or any defect in material or manufacture appears within twelve (12) months from the date of initial purchase by end user Fountain's entire liability, and Customer's or end user's exclusive remedy, shall be, to either repair or replace such defective Equipment, at Fountain's option, within a reasonable time after written notification thereof and return of the defective Equipment to Fountain.

(2) THIS WARRANTY IS MADE IN LIEU OF ALL OTHER WARRANTIES, EXPRESS OR IMPLIED, INCLUDING, BUT NOT LIMITED TO, THE IMPLIED WARRANTY OF MERCHANTABILITY, THE IMPLIED WARRANTY OF FITNESS FOR A PARTICULAR PURPOSE, ANY IMPLIED WARRANTY ARISING OUT OF COURSE OF DEALING OR OF PERFORMANCE, CUSTOM OR USAGE OF TRADE EXCEPT OF TITLE AND AGAINST PATENT INFRINGEMENT.

(3) LIMITATION OF LIABILITIES; TIME LIMIT FOR FILING ACTION. NEITHER PARTY SHALL UNDER ANY CIRCUMSTANCES BE LIABLE TO EACH OTHER FOR DAMAGES OF ANY KIND, INCLUDING, WITHOUT LIMITATION, DIRECT, INDIRECT, INCIDENTAL, SPECIAL OR CONSEQUENTIAL DAMAGES (INCLUDING, BUT NOT LIMITED TO, LOSS OF PROFITS, REVENUE OR BUSINESS) RESULTING FROM OR IN ANY WAY RELATED TO THE EQUIPMENT, ANY OF CUSTOMER'S PURCHASE ORDERS, THESE TERMS AND CONDITIONS OR THE TERMINATION OR NONRENEWAL THEREOF.

FOUNTAIN'S LIABILITY ON ANY CLAIM OF ANY KIND (INCLUDING NEGLIGENCE) FOR ANY LOSS OR DAMAGE ARISING OUT OF OR RESULTING FROM THIS AGREEMENT, OR FROM THE PERFORMANCE OR BREACH THEREOF, OR FROM THE EQUIPMENT FURNISHED HEREUNDER SHALL IN NO CASE EXCEED THE PRICE OF THE SPECIFIC EQUIPMENT WHICH GIVES RISE TO THE CLAIM. ALL SUCH LIABILITY SHALL TERMINATE UPON THE EXPIRATION OF THE WARRANTY PERIOD AS STATED HEREIN.

These limitations apply regardless of whether such damages are sought based on breach of contract, negligence, strict liability in tort or any other legal theory.

(4) Any action for breach of warranty or any other obligation under these Terms and Conditions must be commenced within one (1) year from the purported date of breach.

(5) Each limitation on liability or remedy set forth in these Terms and Conditions is independent of any other limitation or if they are otherwise held to be unenforceable, that shall not affect the validity of any other such limitation or remedy.

Fountain assumes no liability for any claims for injury or damages to persons or property arising from any chemical manufactured by Customers or by any third-party vendors for use in any Fountain's equipment.

Terms or conditions contained in any Customer purchase order or similar document that in any manner purport to alter, modify, change, or suspend these terms shall be deemed excluded from such purchase order and expressly waived by the Customer.

This limited warranty does not cover or include any consumable/wearable products, such as filters or brushes, associated with such equipment.

Fountain assumes no liability for any unauthorized modifications carried out to the equipment not strictly recommended by the factory procedures or recommendations.

This limited warranty is not transferable, and does not cover any general equipment maintenance, demonstration, installation, routine servicing, calibration or customization of any equipment.

No person is authorized to alter or extend this limited warranty unless made in writing and signed by an authorized officer of Fountain.

DOC#: 303-002 REV: G UPDATED: 2/1/16



Fountain Industries LLC  
740 Innovation Drive  
Shakopee, MN 55379

Tel: 800-328-3594  
507-373-2351

Email: [CS@FTNLLC.COM](mailto:CS@FTNLLC.COM)  
Website: [WWW.FOUNTAININDUSTRIES.COM](http://WWW.FOUNTAININDUSTRIES.COM)



